

# Commander 30

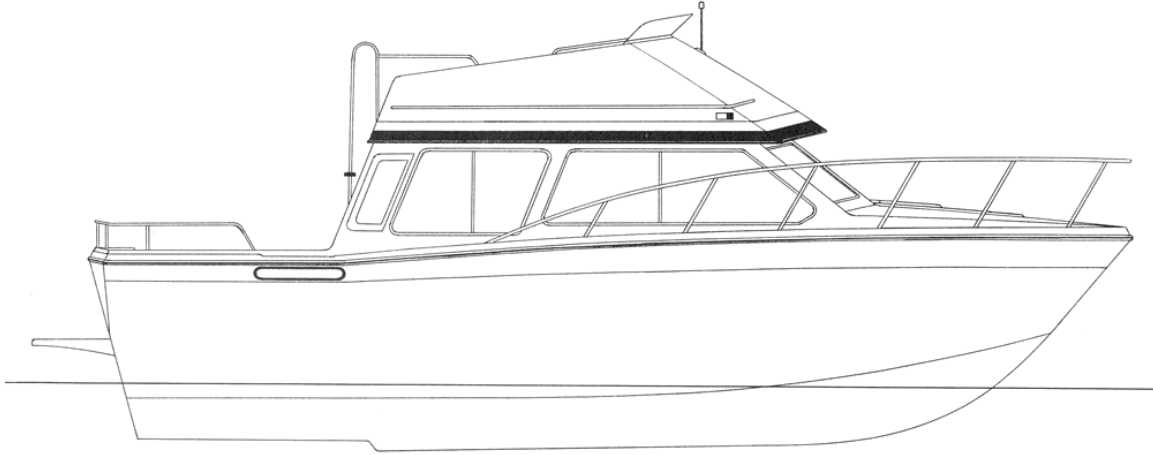

## Commander 30

### 30' Features

- Forward facing passenger seat across from helm seat.
- Sitting room with sofa behind dinette makes into a double berth which can be completely privatized from main cabin with sliding panels and folding door.
- Windows and windshields of tinted safety glass, all with drapes or curtains for privacy and with a screen on each side of boat.
- Hanging locker and two storage compartments in cabin floor.
- Sliding swivel helm bridge seat with twin back to back sleeper/lounge side seats.
- Transom door permits easy boarding from swim grid.
- Overhead console for radio, vapour detector and speakers.
- Upholstered chair in foreberth area in front of makeup drawer with tilting mirror.
- Storage for rolled charts in front of forward facing passenger seat.
- Lift up end table beside sitting room settee.

- Four fluorescent, three incandescent dome and two reading lights in cabin.
- Mirror on sitting room sliding panel.

### 30' Equipment

- Twin V8 gasoline engines with fresh water cooling.
- Blue acrylic individual bridge dash, steering wheel and seat covers.
- One high amperage twelve volt and two deep cycle six volt batteries.
- Individual master switch in cabin for each engine.
- AM/FM CD stereo system with speakers in cabin and on bridge.
- Battery charger.
- Teak convenience rack at forward facing passenger seat.
- Trim tabs with controls at both helm positions.

### 30' Factory Options

- Timer controlled bait tank circulation system.
- Diesel fired cabin heater.
- Electric vertical winch with foot control.
- Bottom Paint.
- Anchor packages.

## 30' SPECIFICATIONS

Item	Metric Measure	Imperial Measure	U.S. Measure
Centre line length	9.06 meters	29'9"	29'9"
Length Overall	9.47 meters	31'1"	31'1"
Beam	3.63 meters	11'11"	11'11"
Height above water line	3.13 meters	10'3"	10'3"
Height overall	3.69 meters	12'1.1/4"	12'1.1/4"
Approximate weight	4626 kilograms	12,000 lbs.	12,000 lbs.
Fuel Capacity	745 litres	164 galls.	197 galls.
Fresh water capacity	265 litres	58.3 galls.	70 galls.

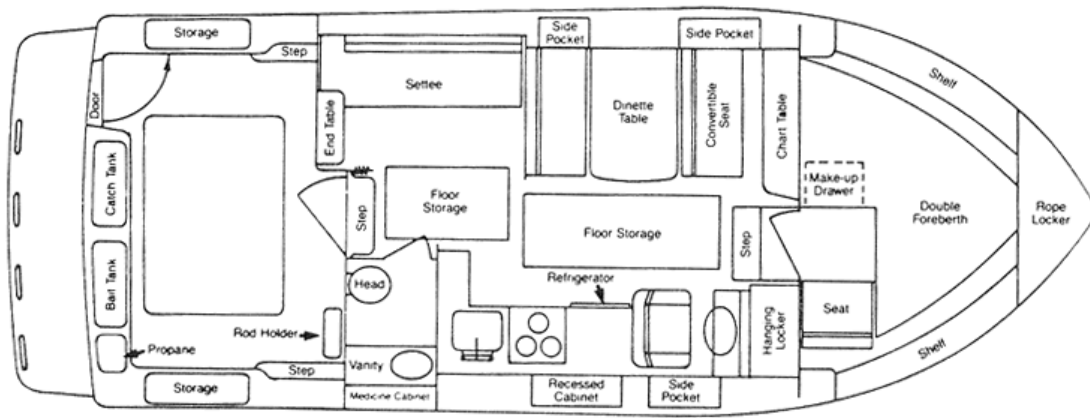

30' STANDARD PLAN

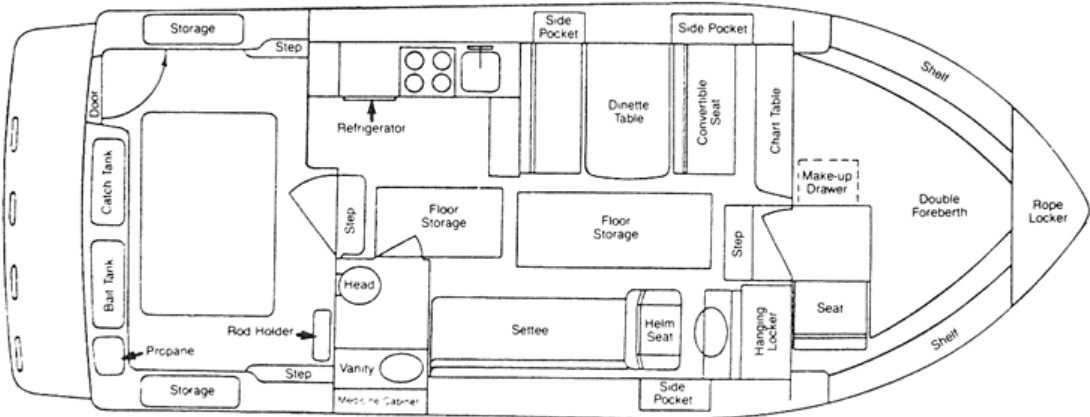

30' ALTERNATE PLAN

## **Commander** Features & Equipment

### Standard Commander Features

- Textured walk around dock facilitates docking and fishing.
- Large aluminum fuel and fresh water tanks situated on centre line to avoid variation in boat trim from changes in fuel and water volume.
- One piece deck design eliminates use of windows as structural components avoiding leaks and breakage inherent in conventional design.
- Upholstered lower helm seat situated well forward for superior vision when under way.
- Enclosed standup head with recessed medicine cabinet, vanity with sink, shower mixer, shower curtain and self draining fiberglass base.
- Teak galley with propane stove and oven, 12 volt refrigerator, sink, four drawers and cupboards, free counter space and a pullout cutting board.
- Pressurized fresh water system provides hot and cold water on demand at both sinks and at shower head.
- Foreberth privacy ensured by full bulkhead and louvred teak door.
- Upholstered four place dinette converts quickly to double berth.
- Drapes or curtains on all windows and windshields.

- Extensive storage forward of bridge bulkhead, in cockpit, engine compartment, under foreberth and dinette, and in galley drawers and cupboards.
- Easily cleaned insulated bait and catch tanks with fiberglass covers to protect and preserve your fish.
- Locking fish rod box in cockpit area protects and stores fish rods.
- Self bailing cockpit with large scuppers.
- Full width fiberglass swim grid with molded hand holds to simplify recovery of swimmers and their equipment.
- Circuit breaker protected shorepower connection with 110 volt outlets at galley, dinette and in engine compartment.
- Hydraulic steering.
- Two cockpit storage compartments with fiberglass covers provide concealed storage.
- One piece engine hatch cover provides easy access to the engine compartment.
- Engine hatch cover release inside main cabin.
- Efficient engine compartment ventilation system.
- Large self bailing rope and chain locker below foredeck.
- Automatic bilge pump also operable manually from both helm positions.
- Full navigation, running and anchor lights.
- Mirrors on inside wall of head and on outside of head door.
- White vinyl head liner adds brightness to the cabin.
- Wired for installation of adequate powered winch.
- Forced air windshield defogging system.
- Light in engine compartment.
- Owners procedures and information manual.

### **Standard Commander Equipment**

- Electric horn on bridge.
- Bow roller, deck pipe and mooring bit on foredeck.
- Full running and anchor lights.
- Dual windshield wipers.
- Compasses at both helm positions.
- Engine hatch cover release in cabin.
- Hand pump oil change kit.
- Automatic bilge pump.
- Hide-a-way garbage container.
- Dish cupboard with dishes.
- Recessed paper towel holder.
- Liquor bottle cabinet.
- Utensil drawer under dinette table.
- Gas vapour detector with alarm.
- Propane tank remote controlled shut off at galley.
- Dry chemical fire extinguisher.
- Hot water tank heated by shore power or by engine cooling system.

- Two speed automotive type cabin heater.
- Shore power connector.
- Propane stove with oven.
- 12/110 volt refrigerator.
- Open shelves in foreberth.

**YOUR COMMANDER DEALER:**



**Showroom 1, 8100 River Road (At Capstan Way),  
Richmond, B.C.**

**V6X 3A3**

**Phone: (604) 273-2226**

**Fax: (604) 273-3167**